



# 1900 - 1950 ST-RÉGIS

## DORVAL, (QUÉBEC)

**INDUSTRIEL - À LOUER**  
**INDUSTRIAL - FOR LEASE**

**JUSQU'À 16 382 PI. CA. DISPONIBLES - UP TO 16 382 SQ. FT. AVAILABLE**

- 2 quais de chargement et 2 drive-ins | 2 loading docks and 2 drive-ins
- Hauteur libre : 16' | Clear height: 16'
- Alimentation électrique : 400A/600V | Power: 400A/600V
- proche de l'aéroport P-E Trudeau | Close to the P-E Trudeau airport
- Proche de la station REM Des Sources | Near the REM Des Sources station
- proche de l'autoroute 40 | Close to Highway 40



**BRASSWATER**

245, avenue Victoria,  
Suite 801  
Westmount, Qc | H3Z 2M6  
T: +1 514 535 4444  
[www.brasswater.ca](http://www.brasswater.ca)

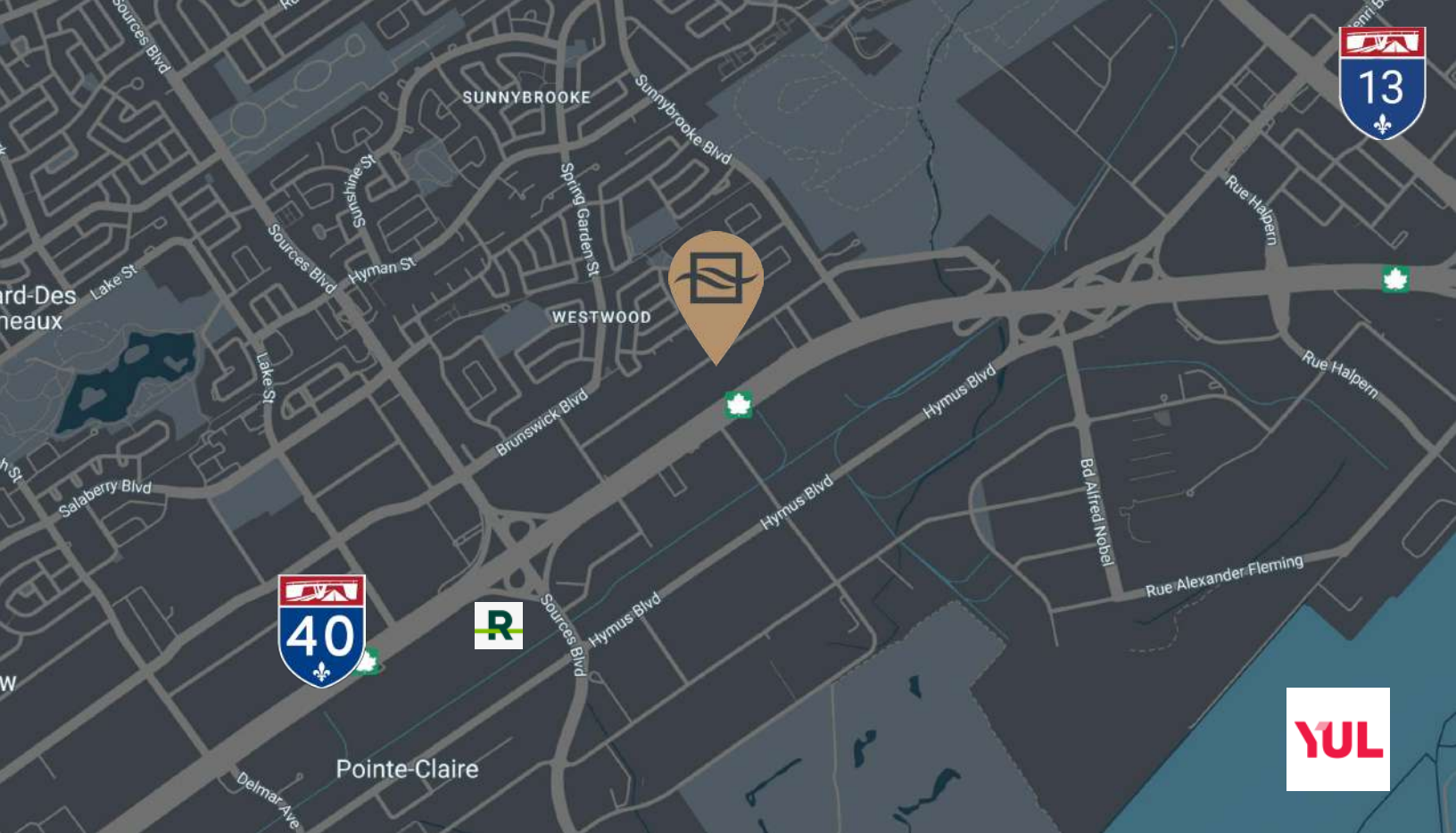

# TRANSPORT

ACCÈS FACILE À L'AUTOROUTE



ET/AND



EASY HIGHWAY ACCESS

# SERVICES ET COMMODITÉS | SERVICES AND AMENITIES

## BANQUES | BANKS

- DESJARDINS
- CIBC
- TD CANADA TRUST
- SCOTIA BANK
- RBC ROYAL BANK
- BMO BANK OF MONTREAL

## RESTAURANTS

- LE BISTRO FIT
- DELISH
- JACK ASTOR'S
- LA BELLE PROVINCE
- AMIR
- PIZZA SPANO
- LAFLEUR
- QUESADA
- SPICEBROS

## COMMERCE | SHOPS

- CANADIAN TIRE
- SPORTS EXPERTS
- PLACE VERTU
- ADONIS
- DOLLARAMA
- WALMART
- GOLD'S GYM
- CINEMA GUZZO
- MEGA CENTRE COTE VERTU
- ENTREPÔT L'ORÉAL
- SHELL

# UNITÉ 1936

## PLAN

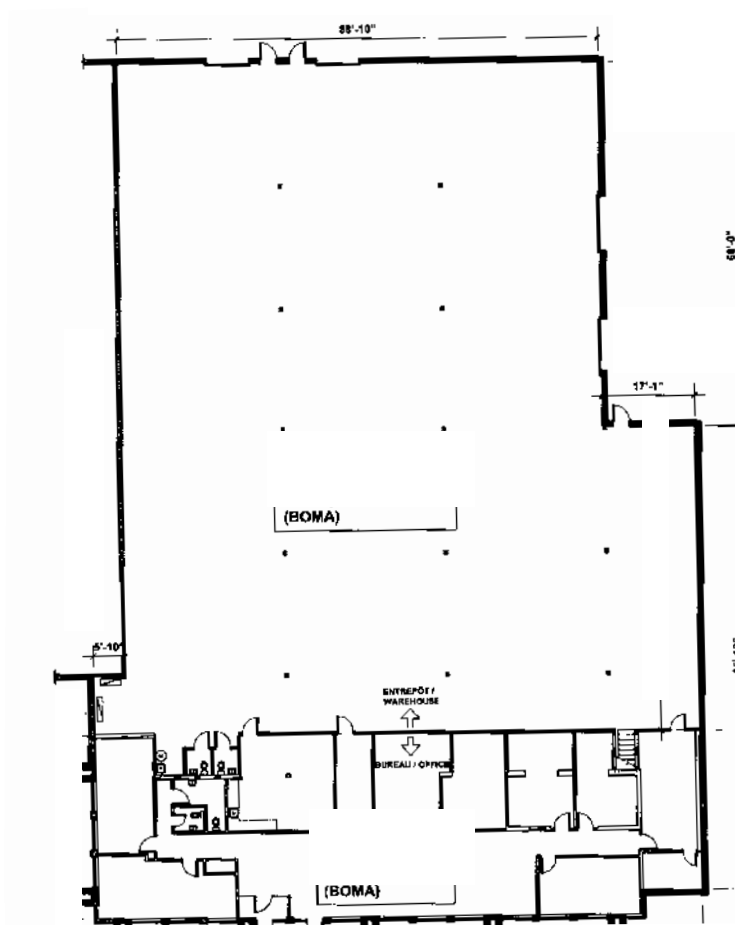

<b>Zonage</b> Zoning	<b>Industriel</b> Industrial
<b>Disponible</b> Available	<b>01/03/2024</b>
<b>Surfaces disponibles (pi. ca.)</b> Available Areas (sq. ft.)	<b>16 382</b>
<b>Portes au sol</b> Drive-in doors	<b>2</b>
<b>Quais de chargement</b> Loading docks	<b>2</b>
<b>Espace de bureau (pi. ca.)</b> Office space (sq. ft.)	<b>3 780</b>

# UNITÉ 1908

## PLAN

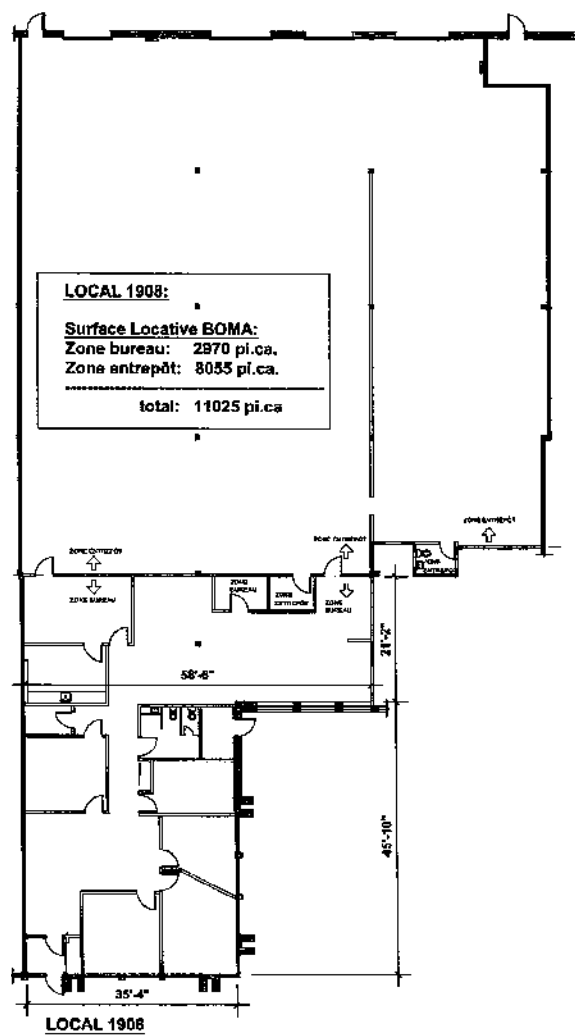

Zonage Zoning	Industriel Industrial
Surfaces disponibles (pi. ca.) Available Areas (sq. ft.)	11 025
Quais de chargement Loading docks	3
Porte au sol Drive-in door	1
Espace de bureau (pi. ca.) Office space (sq. ft.)	2 970

**PHOTOS EXTÉRIEURES**

*UNITÉ 1936*

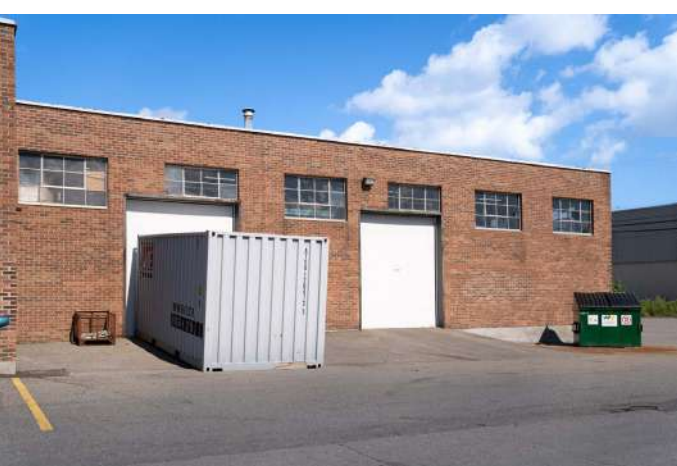

**EXPÉDITION - SHIPPING**

*UNITÉ 1908*





## CONTACTEZ-NOUS | CONTACT US

### **VICTORIA TENENBOYM**

Directrice principale à la location  
*Senior leasing director*

T: +1 514 894 6505  
vtenenboym@brasswater.ca

---

### **JORDAN ALTMAN**

Agent à la location  
*Leasing Agent*

T: +1 514 775 1234  
jaltman@brasswater.ca

---

### **ÉQUIPE DE LOCATION LEASING TEAM**

T: +1 514 535 4444  
leasing@brasswater.ca



**BRASSWATER**

245, avenue Victoria,  
Suite 801  
Westmount, Qc | H3Z 2M6  
T: +1 514 535 4444  
www.brasswater.ca