



# 155-165 AVE LABROSSE POINTE-CLAIRE, QUÉBEC

**INDUSTRIEL - À LOUER**  
**INDUSTRIAL - FOR LEASE**

*JUSQU'À 25 519 PI. CA. - UP TO 25 519 SQ. FT.*

- **3 quais de chargement couverts** | 3 loading docks
- **4 portes au sols** | 4 drive-in
- **18' de hauteur libre** | 18' of clear height
- **Zone d'expédition/réception** | Efficient shipping/receiving area
- **Situé proche d'autoroute 40** | Located close to highway 40



**BRASSWATER**

245, avenue Victoria,  
Suite 801  
Westmount, Qc | H3Z 2M6

T: +1 514 535 4444  
[www.brasswater.ca](http://www.brasswater.ca)

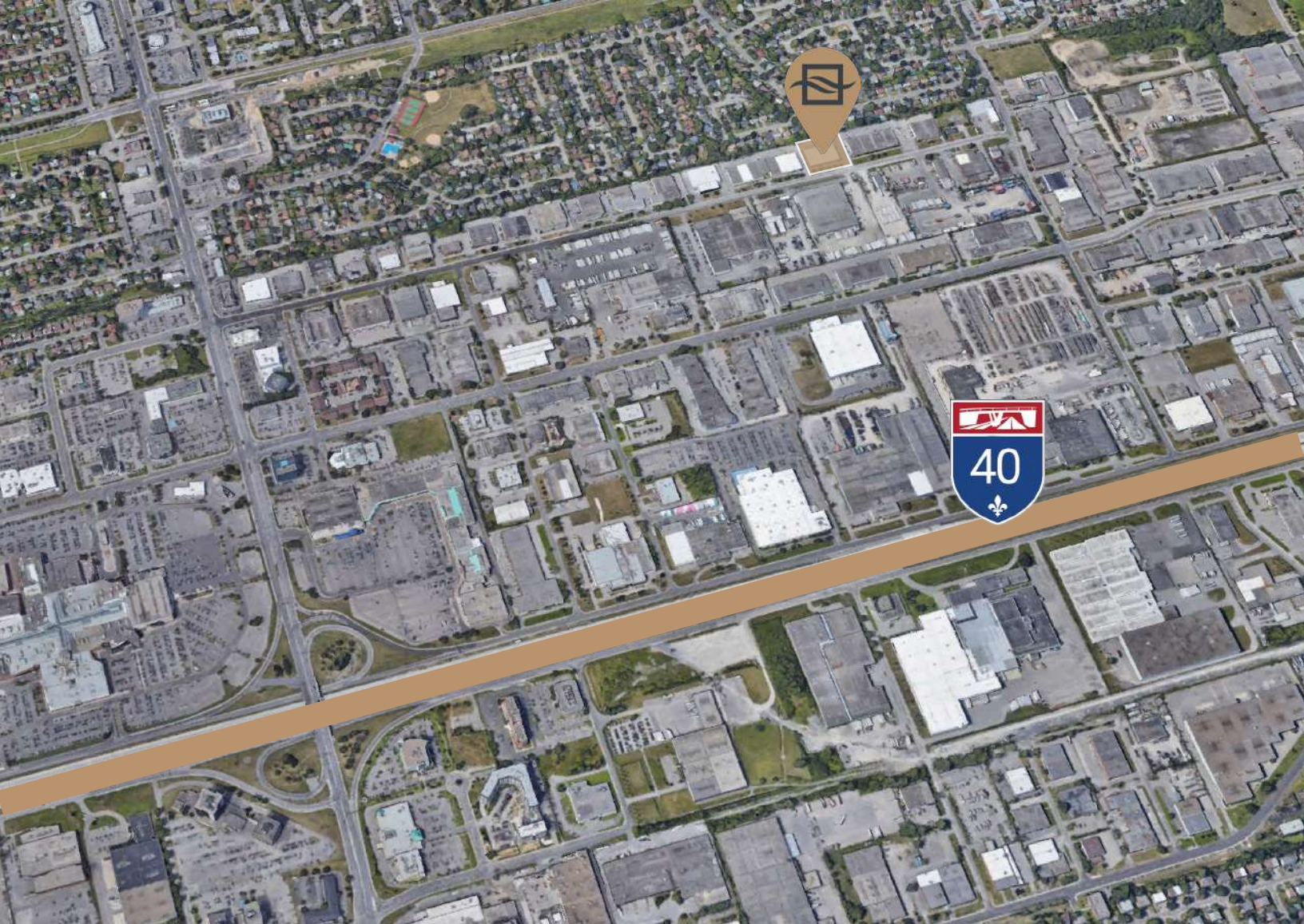

Réseau  
express  
métropolitain



ACCÈS FACILE À L'AUTOROUTE



EASY HIGHWAY ACCESS

## SERVICES ET COMMODITÉS | SERVICES AND AMENITIES

BANQUES | BANKS

TD BANK  
HSBC BANK

RESTAURANTS

STARBUCKS  
MCKIBBINS  
TIM HORTONS  
MCDONALDS  
AMIR

COMMERCE | SHOPS

FAIRVIEW POINTE-CLAIRE  
TOYS R US  
COSTCO  
MAXI

# ESPACE TOTAL - TOTAL SPACE

25 519 PI. CA.

- Quai de chargement
- porte au sol

**MEZZANINE**  
4 685 PI. CA.

**ESPACE: A**  
12 500 PI. CA.

**ESPACE: B**  
13 019 PI. CA.

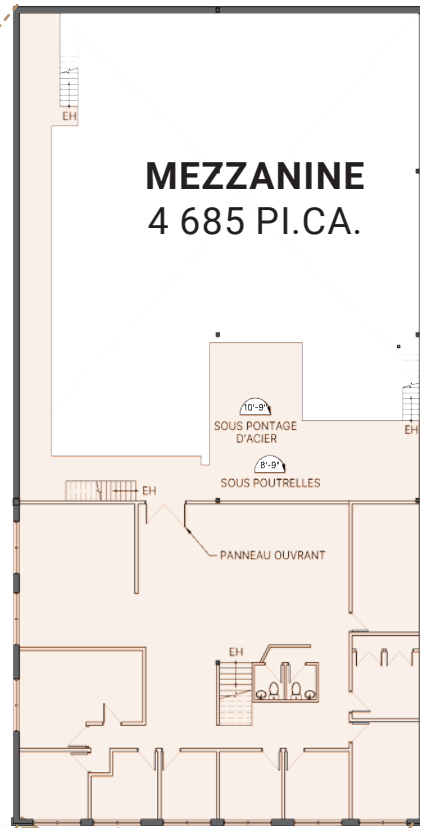
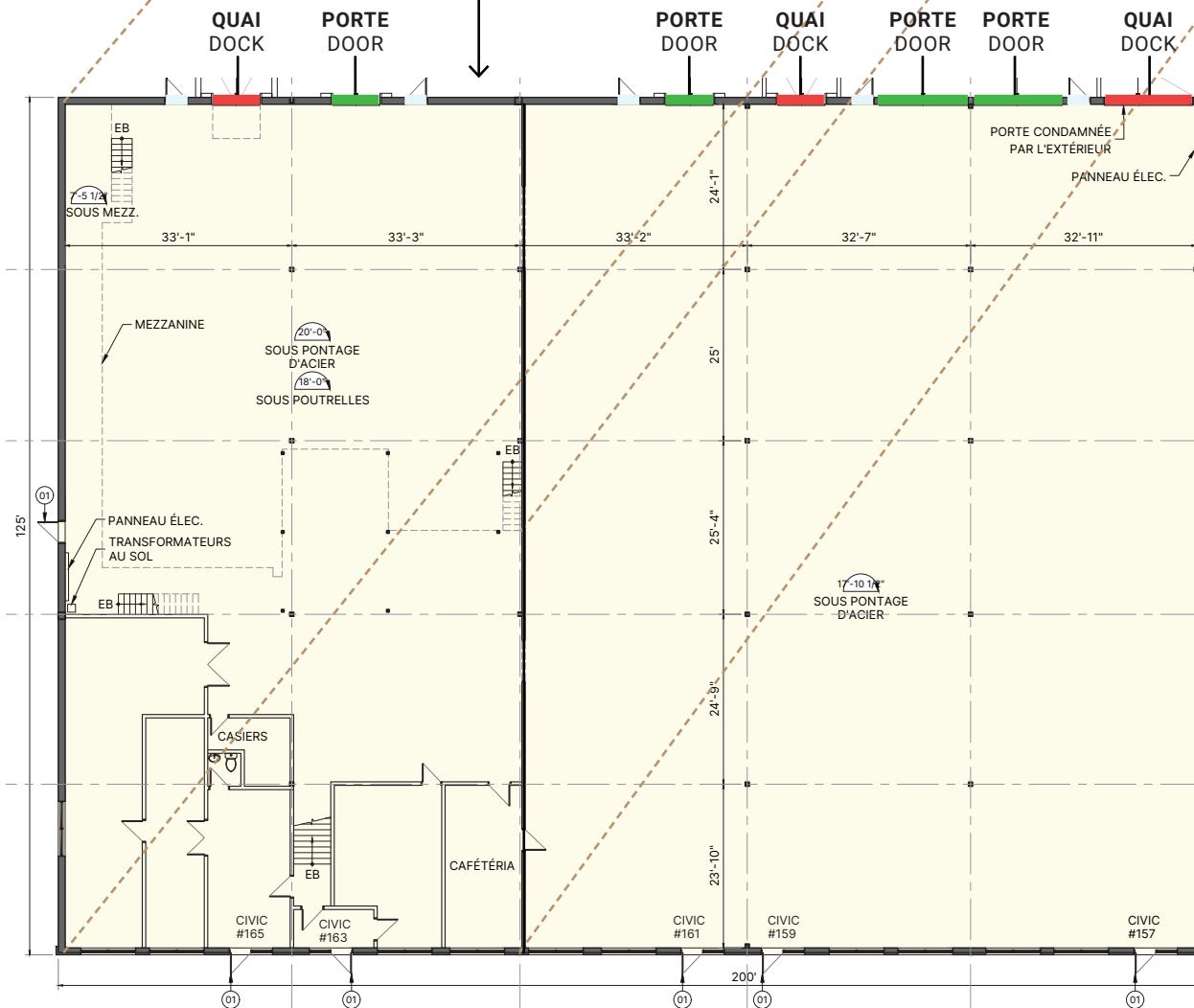

**QUAI DE CHARGEMENT  
LOADING DOCK**



**PORTE AU SOL  
DRIVE-IN**



**ENTREPÔT INTÉRIEUR**  
**INTERIOR WAREHOUSE**





## CONTACTEZ-NOUS | CONTACT US

### **VICTORIA TENENBOYM**

Directrice principale a la location  
*Senior leasing director*

T: +1 514 894 6505  
vtenenboym@brasswater.ca

---

### **JORDAN ALTMAN**

Agent a la location  
Leasing Agent

T: +1 514 775 1234  
jaltman@brasswater.ca

---

### **ÉQUIPE DE LOCATION LEASING TEAM**

T: +1 514 535 4444  
leasing@brasswater.ca



**BRASSWATER**

245, avenue Victoria,  
Suite 801  
Westmount, Qc | H3Z 2M6  
T: +1 514 535 4444  
www.brasswater.ca