



3000 RUE CARTIER SAINT-HYACINTHE, QC

BUREAU - À LOUER
OFFICE - FOR LEASE

11 700 PI. CA. DISPONIBLE - 11 700 SQ. FT. AVAILABLE

- **À proximité de l'autoroute 20** | *In proximity to highway 20*
- **À proximité de nombreux commerces** | *Close to many stores*
- **Espace divisible** | *Divisible space*



BRASSWATER

245, avenue Victoria,
Suite 801
Westmount, Qc | H3Z 2M6
T: +1 514 535 4444
www.brasswater.ca

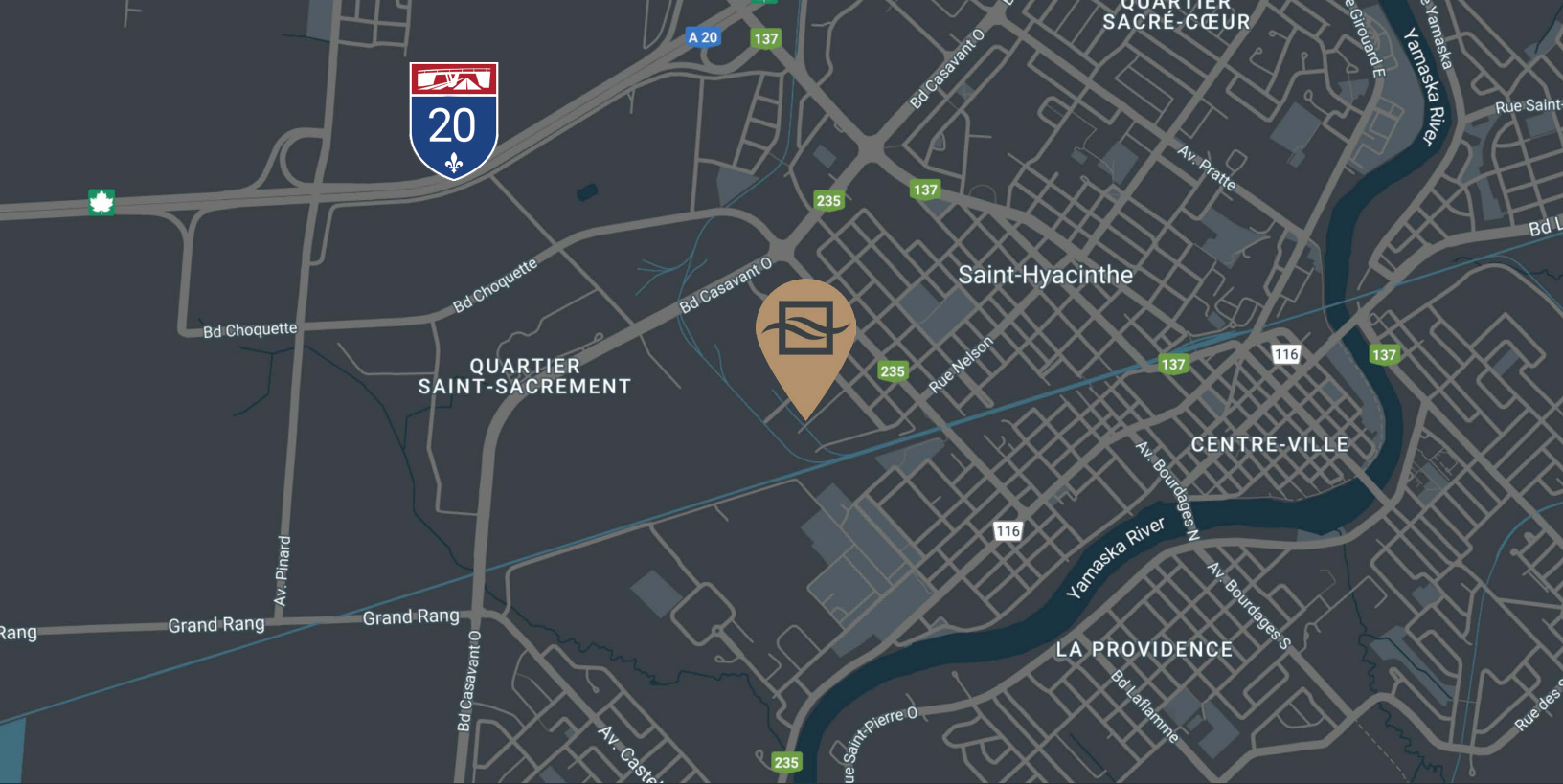

Zonage Zoning	Bureau - Office
Surfaces disponibles (pi. ca.) Available Areas (sq. ft.)	11 700
Accès Autoroute Highway Access	
Ville à proximité Nearby city	À 1,8 km de St-Hyacinthe 1,8 km from downtown St-Hyacinthe

PLAN DU SITE

Espace disponible de 11 700 pi.ca. Divisible

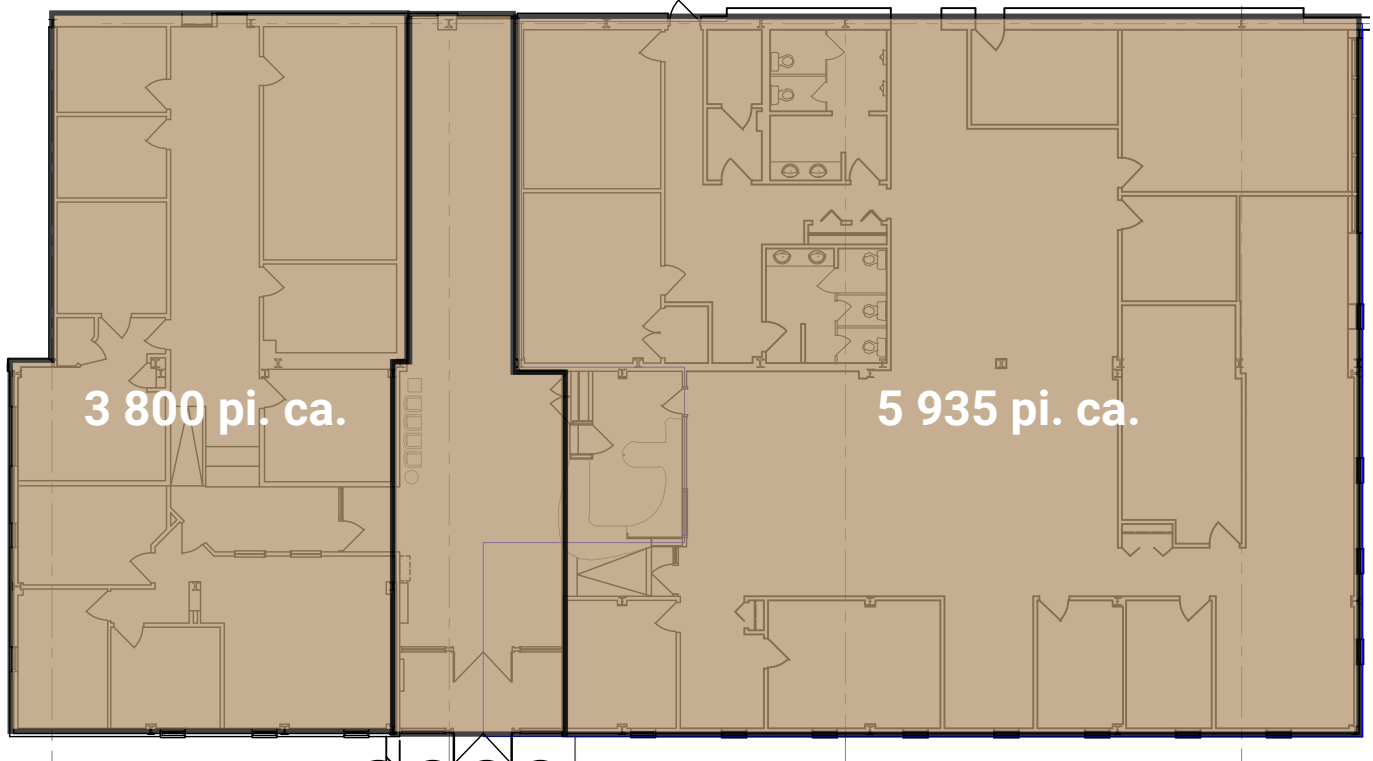
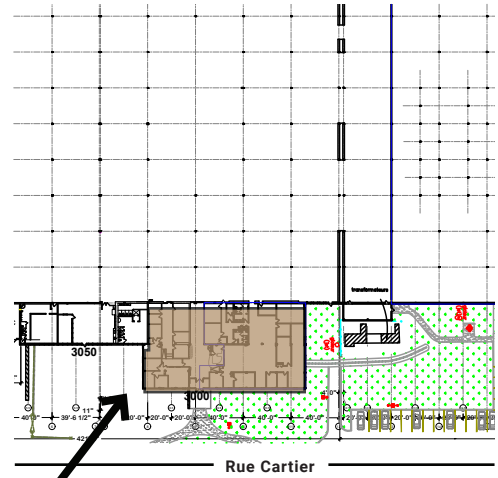



CONTACTEZ-NOUS – CONTACT US

ÉQUIPE DE LOCATION LEASING TEAM

T: +1 514 535 4444
leasing@brasswater.ca

JORDAN ALTMAN

Agent a la location
Leasing Agent
T: +1 514 775 1234
jaltman@brasswater.ca

VICTORIA TENENBOYM

Directrice principale a la location
Senior leasing director
T: +1 514 894 6505
vtenenboym@brasswater.ca



BRASSWATER

245, avenue Victoria,
Suite 801
Westmount, Qc | H3Z 2M6

T: +1 514 535 4444
www.brasswater.ca