



# QUARTIER DELSON DELSON, QUÉBEC

COMMERCIAL - À LOUER  
RETAIL - FOR LEASE

*JUSQU'À 6 214 PI. CA. - UP TO 6 214 SQ. FT.*

- **Près des autoroutes 15 et 132** | *Close to highways 15 and 132*
- **Adjacent à un nouveau développement résidentiel** | *Adjacent to a new residential development*
- **Entouré de détaillants** | *Surrounded by retailers*
- **Vaste aire de stationnement** | *Large parking area*



**BRASSWATER**

245, avenue Victoria,  
Suite 801  
Westmount, Qc | H3Z 2M6  
T: +1 514 535 4444  
[www.brasswater.ca](http://www.brasswater.ca)







  
35,36,40

**P**  
24/7h

TRAFFIC

 32 000  
/DAY

POPULATION

 29,188  
 63,568

## TRANSPORT

## DÉMOGRAPHIQUE | DEMOGRAPHIC

ACCÈS FACILE À L'AUTOROUTE



ET/AND



EASY HIGHWAY ACCESS

## SERVICES ET COMMODITÉS | SERVICES AND AMENITIES

### BANQUES | BANKS

BANQUE NATIONALE  
RBC  
TD CANADA TRUST  
BMO

### RESTAURANTS

HARVEY'S  
CAVA GRECQUE  
TOUJOURS MIKES  
BOUSTAN DELSON  
LA POKE STATION  
DOUBLE PIZZA

### COMMERCE | SHOPS

MODE GIOVANNA  
HOME DEPOT  
WALMART  
MAXI  
PHARMAPRIX  
CANADIAN TIRE  
PASQUIER DELSON

### HOTELS

HOST HOTEL  
L'AUBERGE  
ECONO LODGE



<b>Zonage</b> Zoning	<b>Commerce de détail   Retail</b>
<b>Surface disponible</b> Available space	<b>JUSQU'À</b> <b>UP TO 6 214 pc/sf</b>
<b>Traffic</b>	<b>32,000 autos par jour</b>
<b>Population</b>	<b>345 135 (10KM)</b> <b>951 527 (15KM)</b>

Georges-Gagné

Highway 132

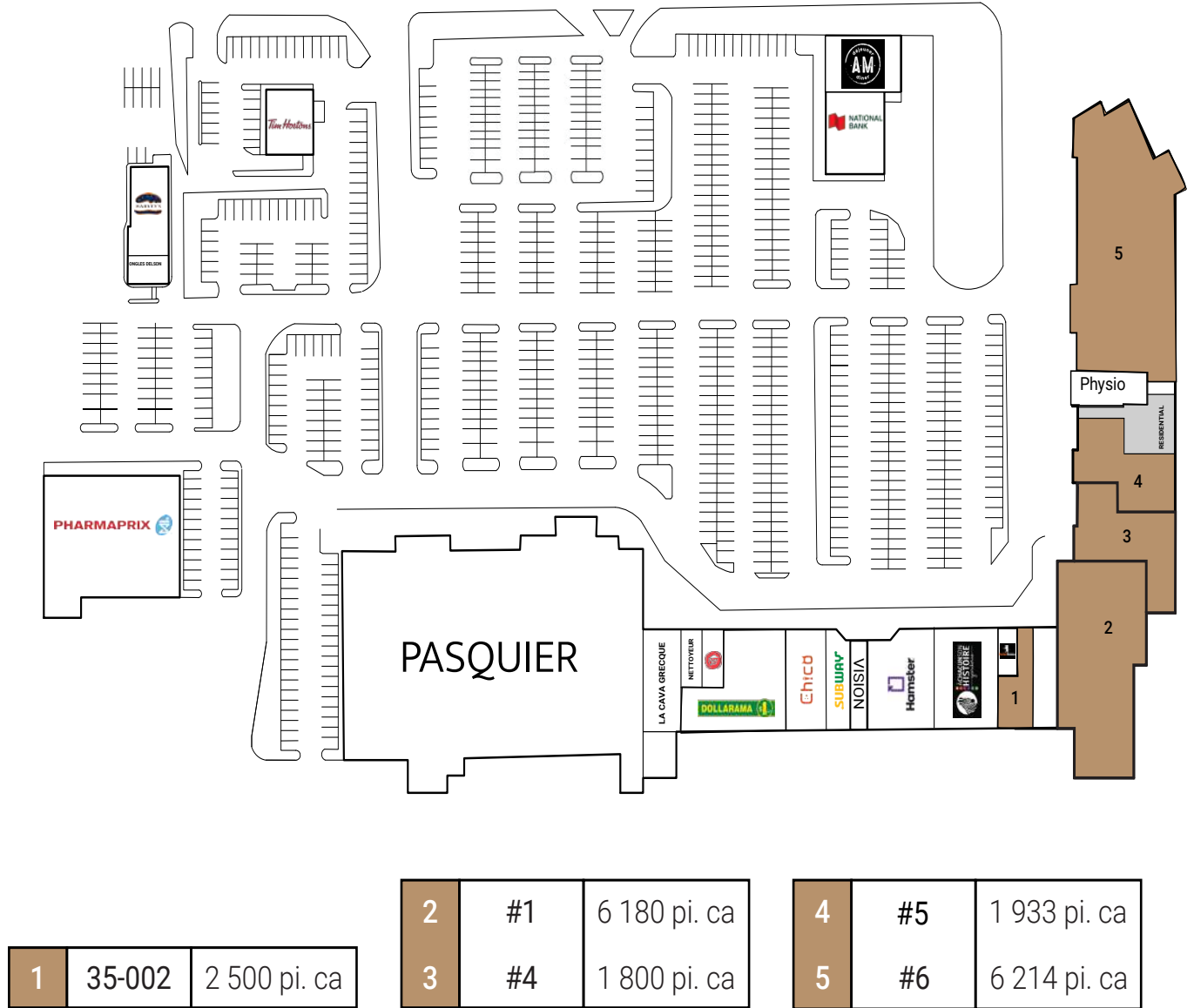

1	35-002	2 500 pi. ca
---	--------	--------------

2	#1	6 180 pi. ca
3	#4	1 800 pi. ca

4	#5	1 933 pi. ca
5	#6	6 214 pi. ca





CONTACTEZ-NOUS | CONTACT US

**ÉQUIPE DE LOCATION  
LEASING TEAM**

T: +1 514 535 4444  
[leasing@brasswater.ca](mailto:leasing@brasswater.ca)

---

**JORDAN KATZ**

Directeur principal, location  
*Senior Leasing Director*

T: +1 514 713 5289  
[jkatz@brasswater.ca](mailto:jkatz@brasswater.ca)



**BRASSWATER**

245, avenue Victoria,  
Suite 801  
Westmount, Qc | H3Z 2M6

T: +1 514 535 4444  
[www.brasswater.ca](http://www.brasswater.ca)